



Bring old world charm home.



CANAMOULD™
EXTERIOR MOULDINGS



TRIMROC™
Interior Plaster Mouldings

CANAMOULD has lead the way with architectural foam products for many years now and continues to grow through innovation and customer commitment. You can create new spaces with exquisite old world charm...let your European memories be a part of your dream home. Our interior and exterior products are available for residential, commercial and high rise projects. Please visit our showroom or website for more information.

101A Roytec Road Woodbridge ON | 905.264.4436 | www.canamould.com

CANAMOULD
EXTRUSIONS INC.

Installation Procedures

1. Substrate must be dry and free of dust or any other “bond breaking” materials. Canamould ornamental decorative trims are intended for use over the primary exterior weather barrier (ie. wall system).
2. Refer to appropriate substrate detail for specific recommendations.

EIFS - Detail A

Masonry - Detail B

Stucco/Cement Plaster - Detail C

Miter Joint - Detail D

3. Apply approved adhesive to back of Canamould™ shape using $\frac{3}{8}$ " notched trowel. (Vertical pattern recommended)
4. While adhesive is wet, immediately install Canamould™ shape and press into place. Remove excess adhesive before it dries.
5. Some pieces may require mechanical attachment until adhesive sets up. For temporary attachment the Wind-lock 302 plate (or equal) with appropriate fastener may be used and then removed prior to the finish coat. For “blind” mechanical attachment into masonry, a stub nail driven into the surface will serve as a temporary hold until the adhesive cures. For “blind” attachment into EIFS, use the Wind-lock™ M-1090 insul-tac as a temporary hold until the adhesive cures.
6. Pieces can be joined using either a miter or straight cut. Check alignment of joints for proper fit prior to embedding Cana-Mesh with approved basecoat over joints.

Miter Plan Detail D

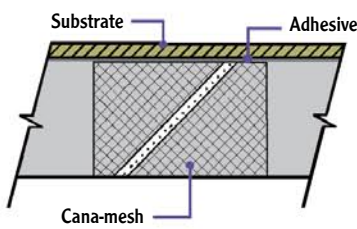

Miter Elevation Detail D

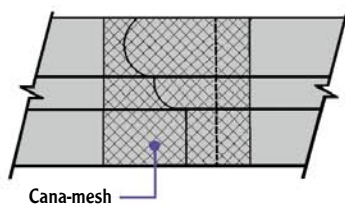

6a. Spline Detail

The following spline detail may be used in lieu of surface/(face) meshing (see 6).

1. Groove insulation board directly behind basecoat (Figure #1) using Wind-lock's™ QC Hot Knife with a I-CANB blade. (Note: for larger pieces groove the EPS board in the middle of the shape also, for more bite.)
2. Apply fibered adhesive mix to both sides. (Figure #2)
3. Press both pieces together and “finger tool” the joint smooth. (Figure #3)



7. Prior to applying finish, ensure that:
 - a. All shapes are completely adhered and fully cured
 - b. All temporary fasteners are removed.
 - c. All joints have been treated and sanded flush.
 - d. All Canamould™ surfaces are clean and free of dirt, dust and other contaminants.

EIFS - Detail A

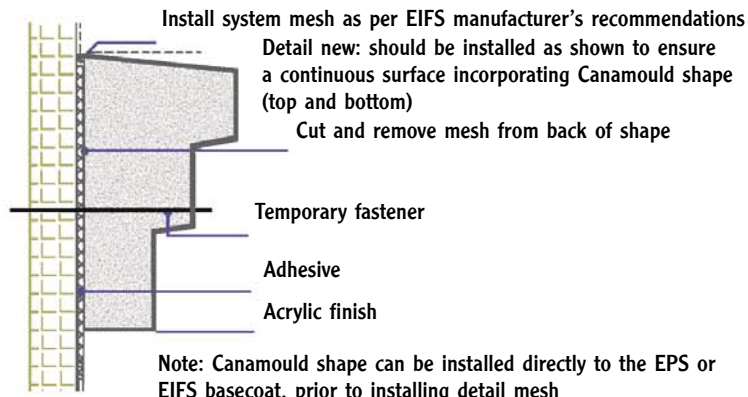

Masonry - Detail B

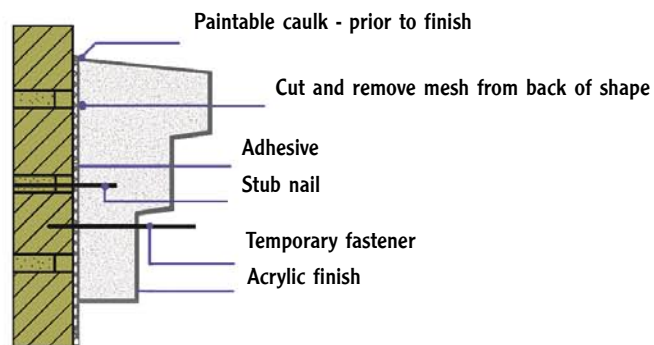

Stucco/Cement - Detail C

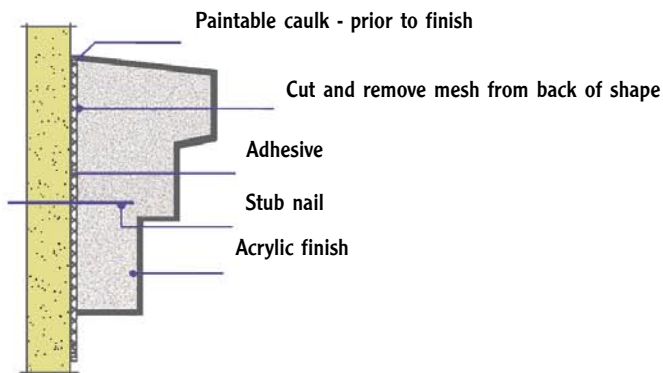

Canamould Extrusions are intended for use as ornamental and aesthetic trims, and NOT as a primary weather barrier. *Flashing and caulking are necessary to prevent moisture intrusion at windows, doors and other penetrations, behind and below Canamould Extrusions. Installation of Canamould Extrusions should be done in coordination with appropriate flashings and should not interfere with the proper function of windows, doors, weep holes, etc.

**CALL CANAMOULD FOR JOB SPECIFIC ASSISTANCE.
1-800-238-2541**

