



DOW® ADHESIVES AND SEALANTS

SIGNATURE PRODUCT



Industry-leading valve allows for multiple uses.



Now offering Great Stuff™ consumer line of sealants and insulation. Call for details.

1. EnerFoam™ Professional Foam Sealant

EnerFoam™ is ideal for applications including insulation, hole and crack filling, blocking insects and acoustical sealing (STC 69).

Part Code	Description	List	Approx Wt
NS W-EF24RS20	Reusable Straw Dispenser Case of 12, 20 oz cans	CALL	23 lb
NS W-EF2520	Gun Dispenser Case of 12, 20 oz cans	CALL	23 lb
W-EF4226	Gun Dispenser Case of 12, 26 oz cans	CALL	28 lb
NS W-EF4320B	Landscape Adhesive Black Gun Dispenser Case of 12, 20 oz cans	CALL	25 lb

NS=Not shown.

2. Great Stuff™ Pro Gaps & Cracks

For filling and air-sealing small holes, gaps and cracks, also acts as a fireblocking material to help prevent the spread of fire and smoke.

Part Code	Description	List	Approx Wt
NS W-GSGC20	Gun Dispenser Case of 12, 20 oz cans	CALL	25 lb
W-GSGC26	Gun Dispenser Case of 12, 26 oz cans	CALL	28 lb
NS W-GSGCRS20	Reusable Straw Dispenser Case of 12, 20 oz cans	CALL	25 lb
NS W-GSGCRS26	Reusable Straw Dispenser Case of 12, 26 oz cans	CALL	28 lb

NS=Not shown.

3. Great Stuff™ Pro Window and Door

Flexible seal permits expansion and contraction of foam, making it the preferred insulating foam sealant for filling the gap between a window or door and its rough opening.

Part Code	Description	List	Approx Wt
W-GSWD	Gun Dispenser Case of 12, 20 oz cans	CALL	21 lb
NS W-GSWD245	Gun Dispenser Case of 12, 24.5 oz cans	CALL	28 lb
NS W-GSTWD	Straw Dispenser Case of 12, 20 oz cans	CALL	21 lb
NS W-GSWDRS20	Reusable Straw Dispenser Case of 12, 20 oz cans	CALL	21 lb
NS W-GSWDRS245	Reusable Straw Dispenser Case of 12, 24.5 oz cans	CALL	28 lb

NS=Not shown.

4. Great Stuff™ Pro Wall and Floor Adhesive

One can is equal to 15 tubes of one-quart adhesive caulk. The product also reduces the number of mechanical fasteners needed—resulting in less material costs and fewer drywall nail “pops.”

Part Code	Description	List	Approx Wt
W-GSWF	Gun Dispenser Case of 12, 24 oz cans	CALL	28 lb

5. Great Stuff™ Pro Gun Cleaner

Cleaner for dispensing guns and removing uncured foam.

Part Code	Description	List	Approx Wt
W-GCCS	Dow Foam Gun Cleaner Case of 12, 12 oz cans	CALL	15 lb

6. Dow® Foam Guns

Foam applicator guns with convenient re-startable, non-drip features developed for use with Dow® Foam Guns.

Part Code	Description	List	Approx Wt
A W-DEG13	Pro13 Gun	\$37.03	1 lb
B W-DEG14	Pro14 Gun	\$65.83	2 lb
NS W-DEG14L	Pro26.5 Long-Barrel Gun	\$113.40	3 lb
C W-DEG15	Pro15 Gun	\$121.23	2 lb
NS W-DEG14BT	Brass tips for W-DEG14	\$3.75	1 lb

NS=Not shown.



6A



6B



6C



PROPER ATTACHMENT OF FOAM GUNS

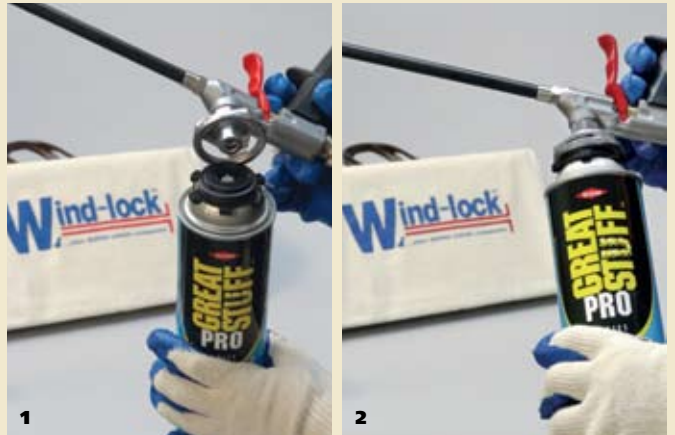

1

2



3

4



5

6

1. Attach the gun to the can of Dow® Great Stuff™ Pro.
2. Always point the can away from your face.
3. Shake can for 1 minute and immediately purge the air from gun.
4. After removing the can from gun, clean the gun adapter with the Dow® Cleaner.
5. Attach can to gun. Always point the can away from your face.
6. Spray the cleaner through the gun.



DOW® SEALANTS, INSULATIONS AND ADHESIVES SIGNATURE PRODUCT



1. Dow® Froth-Pak® Two Component Foam

Froth-Pak® is a foam machine in a carton. Chemical curing allows two-part polyurethane foam to be dispensed, expand and become tack-free in seconds. Froth-Pak® will skin over in 30–40 seconds and be completely cured in under one minute. Froth-Pak® is typically used as a foam-insulating sealant to fill cavities, wall and floor penetrations, cracks and expansion joints.

Froth-Pak® 12

Great for small jobs/12 Board Feet, 1 Cubic Foot

KIT INCLUDES: Iso (A) can, Polyol (B) can, thumb-controlled spray dispenser with hoses, shoulder strap assembly, 2 cone spray nozzles.

Part Code	Description	List	Approx Wt
A W-1FRPK12	Single Kit/Sealant	CALL	4 lb
A W-FRPK12	Case of 12 Kits/Sealant	CALL	40 lb

Froth-Pak® 180

200 Board Feet/16.6 Cubic Feet

KIT INCLUDES: Iso (A) cylinder, Polyol (B) cylinder, 6 cone spray nozzles, 4 GG spray nozzles, 9-ft gun hose assembly, petroleum jelly packet.

Part Code	Description	List	Approx Wt
B W-FRPK180	Single Kit/Sealant	CALL	39 lb
B W-FP18025FS	Single Kit, Class 1/Insulation	CALL	39 lb

Froth-Pak® 600

600 Board Feet/50 Cubic Feet

KIT INCLUDES: Iso (A) cylinder, Polyol (B) cylinder, 8 cone spray nozzles, 4 fan spray nozzles, 15-ft gun hose assembly, petroleum jelly packet.

Part Code	Description	List	Approx Wt
C W-FP600	1–3 Part Kit/Sealant	CALL	117 lb
C W-FP60025FS	1–3 Part Kit, Class 1/Insulation	CALL	118 lb

NS=Not shown.

2. Froth-Pak® 160 Slow Rise

Low pressure foam for blind cavity and abandoned pipe filling. 160 Board Feet/13.3 Cubic Feet

Part Code	Description	List	Approx Wt
W-FP160SR	Single Kit/Sealant	CALL	39 lb

3. Insta-Stik™ Adhesive

Insta-Stik™ is a professional polyurethane adhesive for attaching compatible roof insulation boards to roof decks and substrates in new commercial construction and roof replacement applications.

KIT INCLUDES: Tank, hose, wand, flared nozzle, coupler, valve, wrench and instructions.

Part Code	Description	List	Approx Wt
W-ISTKK	Complete Insta-Stik Kit	CALL	28 lb
W-ISTKT	Insta-Stik Tank Only	CALL	28 lb

See www.wind-lock.com for technical information.
Replacement nozzles available, please call for more information.



DOW® WEATHERMATE™ WEATHERIZATION

SIGNATURE PRODUCT

1. Dow® Weathermate™ Sill Pan

Weathermate™ Sill Pan is a translucent, molded polymer that is manufactured to ensure a consistent thickness. It will not rust or rot and is compatible with standard adhesives and sealants. It provides seamless protection at sill corners and assists positive drainage of water to the exterior. The two-piece design adjusts to fit most window sill widths.

Part Code	Description	List	Approx Wt
W-DSP5	5" h x 3-3/4" d x 32" w 3/8" h backdam	CALL	1 lb

2. Dow® Weathermate™ Construction Tape

Weathermate™ Construction Tape is recommended to seal the joints and seams of Styrofoam™ Weathermate™ housewraps and Styrofoam insulated sheathings. In these applications, Weathermate™ Construction Tape enhances resistance to moisture and air infiltration. The tape can also be used to repair damaged foam insulation or housewrap, reducing material costs and job-site waste.

Part Code	Description	List	Approx Wt
W-DCT178	1-7/8" x 165'	CALL	1 lb
W-DCT278	2-7/8" x 165'	CALL	1 lb

3. Dow® Weathermate™ Straight Flashing

Weathermate™ Straight Flashing combines a blue high-density polyethylene (HDPE) film facer with a butyl rubber adhesive that forms a strong mechanical and chemical bond to most building materials. A polymeric-coated paper release liner provides a more consistent peel than plain paper liners. It provides seamless protection at jambs and straight heads.

Part Code	Description	List	Approx Wt
W-DSF4	4" x 100'	CALL	5 lb
W-DSF6	6" x 100'	CALL	8 lb
W-DSF9	9" x 100'	CALL	12 lb

4. Dow® Weathermate™ Flexible Flashing

Weathermate™ Flexible Flashing combines a blue creped high-density polyethylene (HDPE) film facer with a butyl rubber adhesive that forms a strong mechanical and chemical bond to most building materials. A polymeric-coated kraft paper release liner provides a more consistent peel than plain paper liners. It provides seamless protection around curved openings and custom shapes.

Part Code	Description	List	Approx Wt
W-DFF6	6" x 75'	CALL	11 lb
W-DFF9	9" x 75'	CALL	17 lb

5. Dow® Weathermate™ Housewrap—Plus NEW!

Weathermate™ Housewrap—Plus is a non-woven, non-perforated, polyolefin-based housewrap that offers exceptional tear resistance and durability. It is an effective option for builders who prefer to use non-insulating sheathing along with housewrap. When installed over sheathing, Weathermate™ Housewrap—Plus reduces costly air and moisture infiltration. It is translucent to allow a clear view of the studs and the sheathing surface during installation.

Part Code	Description	List	Approx Wt
W-DWM3165	3'x165' roll	CALL	14 lbs/roll
W-DWM5100	5'x100' roll	CALL	14 lbs/roll
W-DWM9100	9'x100' roll	CALL	24 lbs/roll
W-DWM9150	9'x150' roll	CALL	34 lbs/roll

All other DOW Weathermate—Plus sizes are available. Please call.